

QUICK INSTALLATION GUIDE FOR AIMPOINT® ACRO

1. Disassembly of the original clamping jaw



- Loosen the screw of the ACRO assembly and remove the clamp jaw. **The same screw is used to mount the ACRO assembly!**
- The ACRO assembly with the original clamp jaw is now disassembled.

2. Assembly of ACRO with ASM



- Place the part with the screw recess on the accessory rail from the right.
- Install the counterpart from the left.

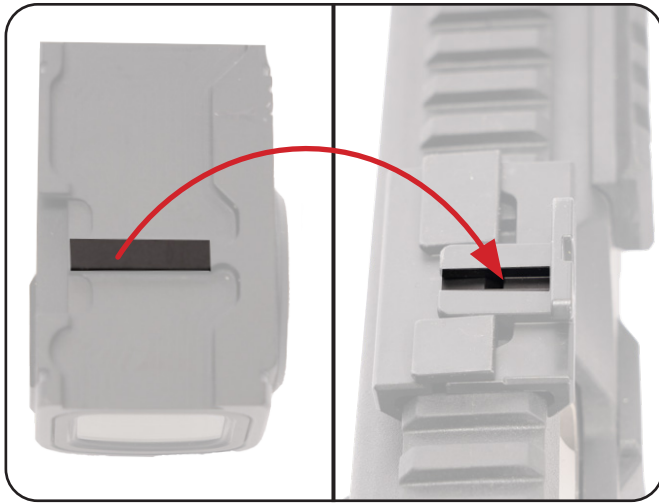

- The stop of the Aimpoint must be positioned in the recess.
- Slide the ACRO onto the rail from the left.



- Insert the screw into the screw recess of the Aimpoint.
- Use the Aimpoint Tool or a Torx wrench size 10 to tighten to approx. 1 Nm.

All rights reserved. The data provided are solely for the purpose of product description and are not to be understood as warranted properties in the legal sense. The information does not release the user from his own assessments and tests. Due to continuous product improvements, the product specifications contained in this data sheet are subject to change.