

INSTALLATION QD SYSTEM

OPERATOR MANUAL

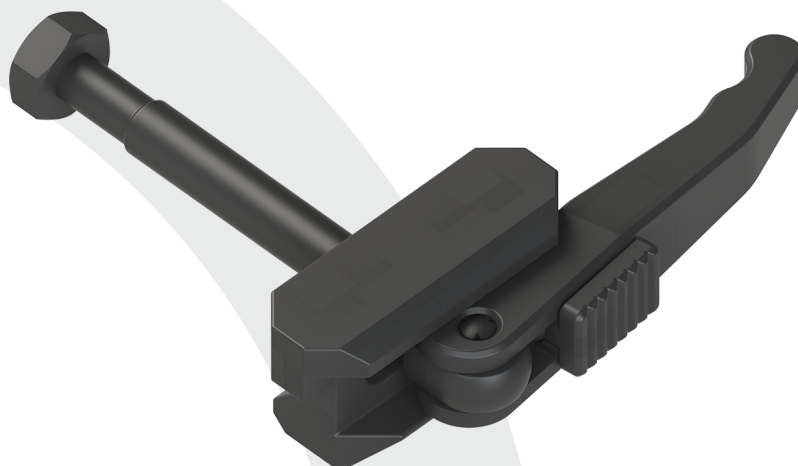

B&T AG
3608 Thun • Switzerland
Tel +41 33 334 67 00
info@bt-ag.ch
www.bt-ag.ch

EYE PROTECTION MUST BE WORN!



SAFETY GOGGLES MUST BE WORN WHEN DISASSEMBLING AND REASSEMBLING THE GUN. PARTS CAN GET INTO THE EYES IF HANDLED INCORRECTLY.

EAR PROTECTION MUST BE WORN!



SUITABLE HEARING PROTECTION MUST ALWAYS BE WORN WHEN SHOOTING WITH A FIREARM.

Table of Contents:

- 1. Overview of versions4
- 2. Mounting of the QD system.....5
 - 2.1 Set version 1 and 26
 - 2.2 Set version 3.....6
- 3. Warranty statement7

1. Overview of versions

The version of the QD system can be determined from the overview.

Version 1



Version 2



Version 3



2. Mounting of the QD system

- a. Release the lever by pushing the lock toward the end of the lever.

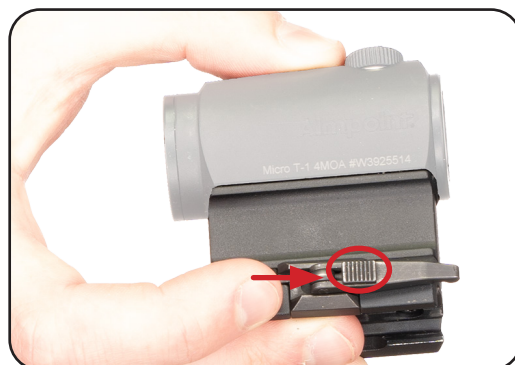

- b. Place the amount on the accessory rail with the V-shaped recess.
» Mostly from the right in the direction of shooting.



- c. Close the lever to hold the assembly in place.

ATTENTION!	
	When the lever is at 45 degrees, resistance should be felt. If so, the assembly is set correctly. If not, it must be adjusted according to 2.1 or 2.2.





- d. The lock shall snap audibly in place.

- e. To release the assembly, slide the lock toward the end of the lever and release the lever. The assembly can now be removed.



2.1 Set version 1 and 2

Advice	
	The following tool is required for adjustment: Version 1: A 5.5mm combination spanner Version 2: A 5.5mm hexagon socket

Advice	
	A maximum of 45° should be adjusted per pass.

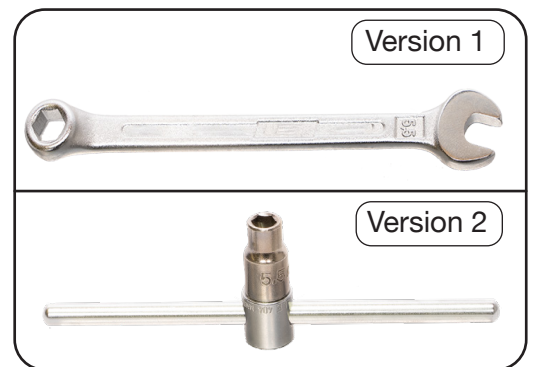

- To loosen the nut, turn it clockwise.
- To tighten the nut, turn it counterclockwise.

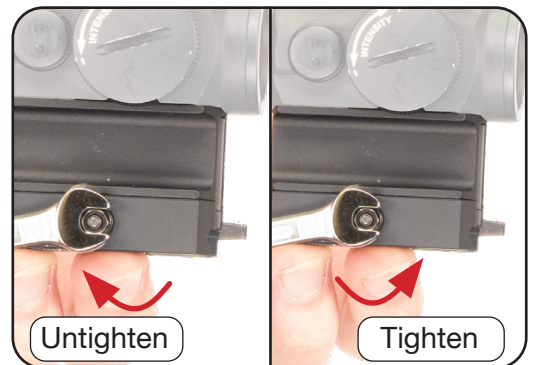

2.2 Set version 3

- Open the lever.
- Push the nut against the mount.
- To loosen, turn the nut clockwise by hand. Turn counterclockwise to tighten.

Advice	
	A maximum of 60° (one face of the hex nut) should be adjusted per pass.

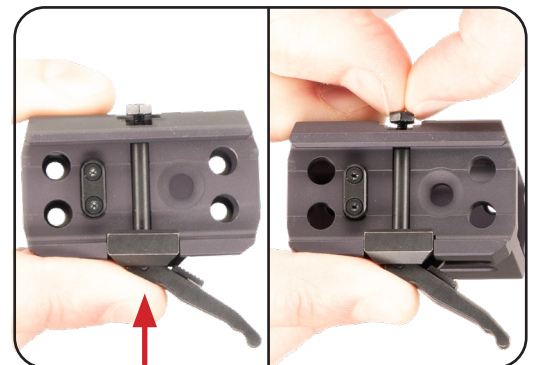

ATTENTION!	
	The nut must be positioned after rotation so that it fits into the recess and does not protrude.

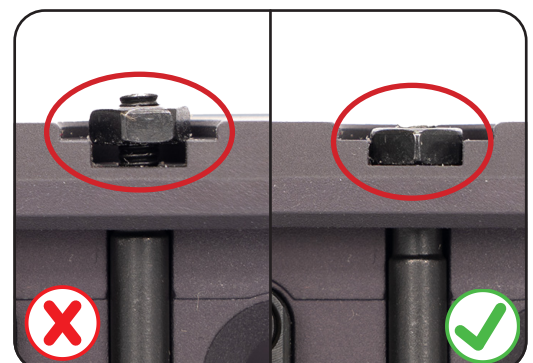

3. Warranty statement

Warranty claims on behalf of the Client are to be explicitly declared as such. During the legal warranty period, B&T provides warranty cover solely for defects that arise as a result of faulty materials, construction errors or poor workmanship. If a warranty claim is justified, B&T will, at its own discretion, either repair or replace the defective good. Costs incurred in transporting the defective good to B&T are borne by the Client. Spare parts fitted and replaced become the property of B&T.

Inasmuch as is legally permitted, any other liability of B&T is excluded, in particular liability for damages arising either directly or indirectly from the delivered good itself, from its use or from its defects.

Merchandise is covered by the warranty provisions of the manufacturer. Parts that are naturally subject to wear and tear, damage arising from insufficient maintenance work, noncompliance with operating regulations and cases of force majeure are all excluded from warranty cover. Warranty claims lapse if the Client itself or third parties alter or repair the delivered good without the prior written consent of B&T. All product specifications are subject to change without prior notice. Published data are mean values and therefore not suitable acceptance criteria.

The manufacturer:

B&T AG - 3608 Thun - Switzerland

Tel +41 33 334 67 00

e-mail: info@bt-ag.com

Notes:

This image shows a full page of blank graph paper. The grid consists of small, uniform squares formed by thin, light gray lines. The grid covers the entire area of the page, leaving no margins or other markings.